

## G2 SERIES – UNDER HEADER MOUNTED COMMERCIAL VINYL DOOR INSTALLATION INSTRUCTIONS

READ THIS MANUAL CAREFULLY. OBSERVE WARNINGS AND PRACTICE CAUTION WHEN INSTALLING, OPERATING, OR MAINTAINING YOUR GOFF'S DOOR ASSEMBLY.



## PREPARE MOUNTING SURFACE AND SECURE MAIN HEADER BRACKETS

**Note:** Check the door opening Header for level, then adjust the installation accordingly.

1. At the upper Left of the opening, use the L.H. Header Mounting Bracket to transfer the hole locations to the mounting surface, and install this bracket. (Figure 1 LOCATE & INSTALL L.H.HEADER MOUNTING BRACKET)
2. At the upper right of the opening, use the R.H. Header Mounting Bracket to transfer the hole locations to the mounting surface, and install this bracket. (Figure 2 LOCATE & INSTALL R.H. HEADER MOUNTING BRACKET)

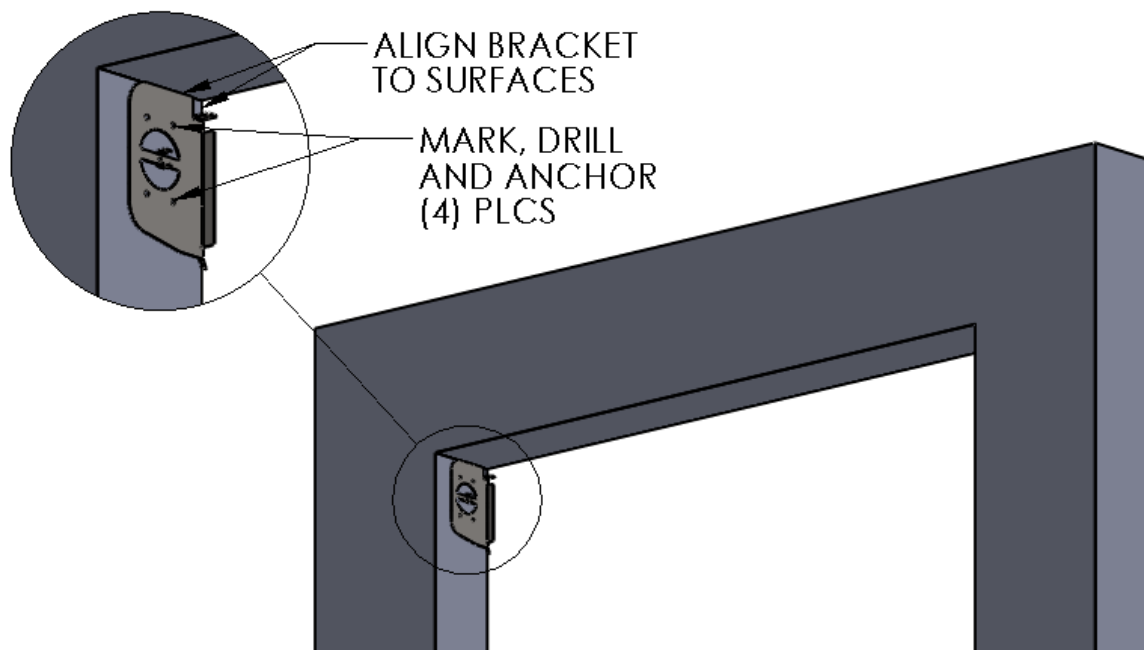

Figure 1 LOCATE & INSTALL L.H.HEADER MOUNTING BRACKET

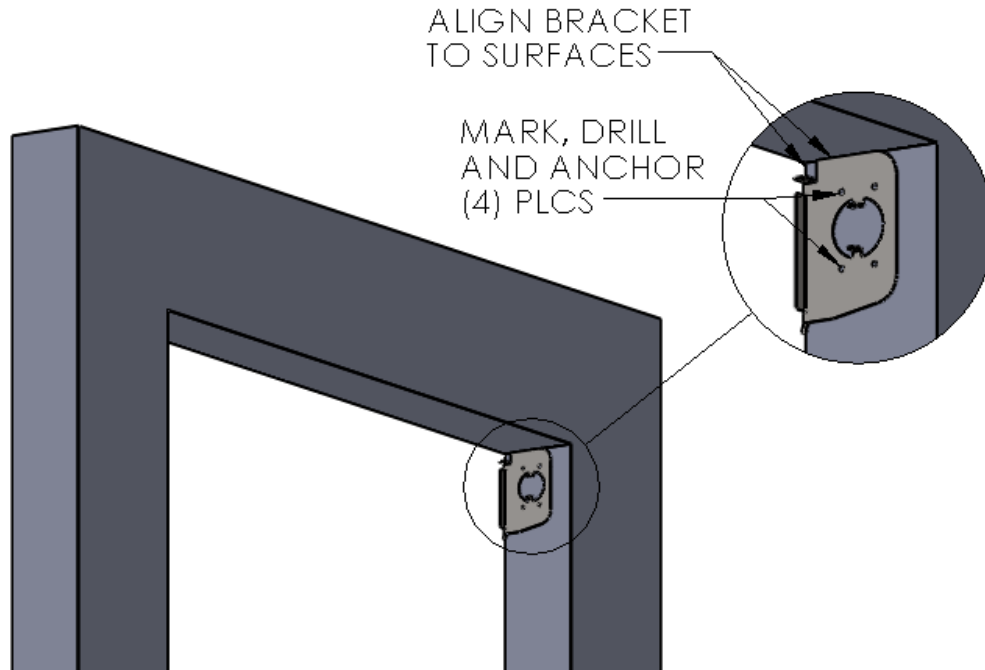

Figure 2 LOCATE & INSTALL R.H. HEADER MOUNTING BRACKET

### **MOUNT THE VERTICAL TRACKS**

1. To locate the Track Assemblies, align the top and back surfaces of the Track to the bottom edge and tab of the Header Mounting Bracket. (Figure 3 LOCATE, MARK, INSTALL TRACK ASSEMBLIES)
2. Plumb the Track Assembly to make sure it is vertically aligned. (Usually with two people, one holding the Track Assembly in place, use a marker to trace the mounting holes on the wall to mark their pilot hole locations.)
3. Move the track assembly off to the side and predrill its mounting holes. Move it back into place and secure it to the wall with appropriate hardware. Before fully tightening hardware, be sure to each track is plumb/vertical.
4. Repeat for the other Track Assembly.

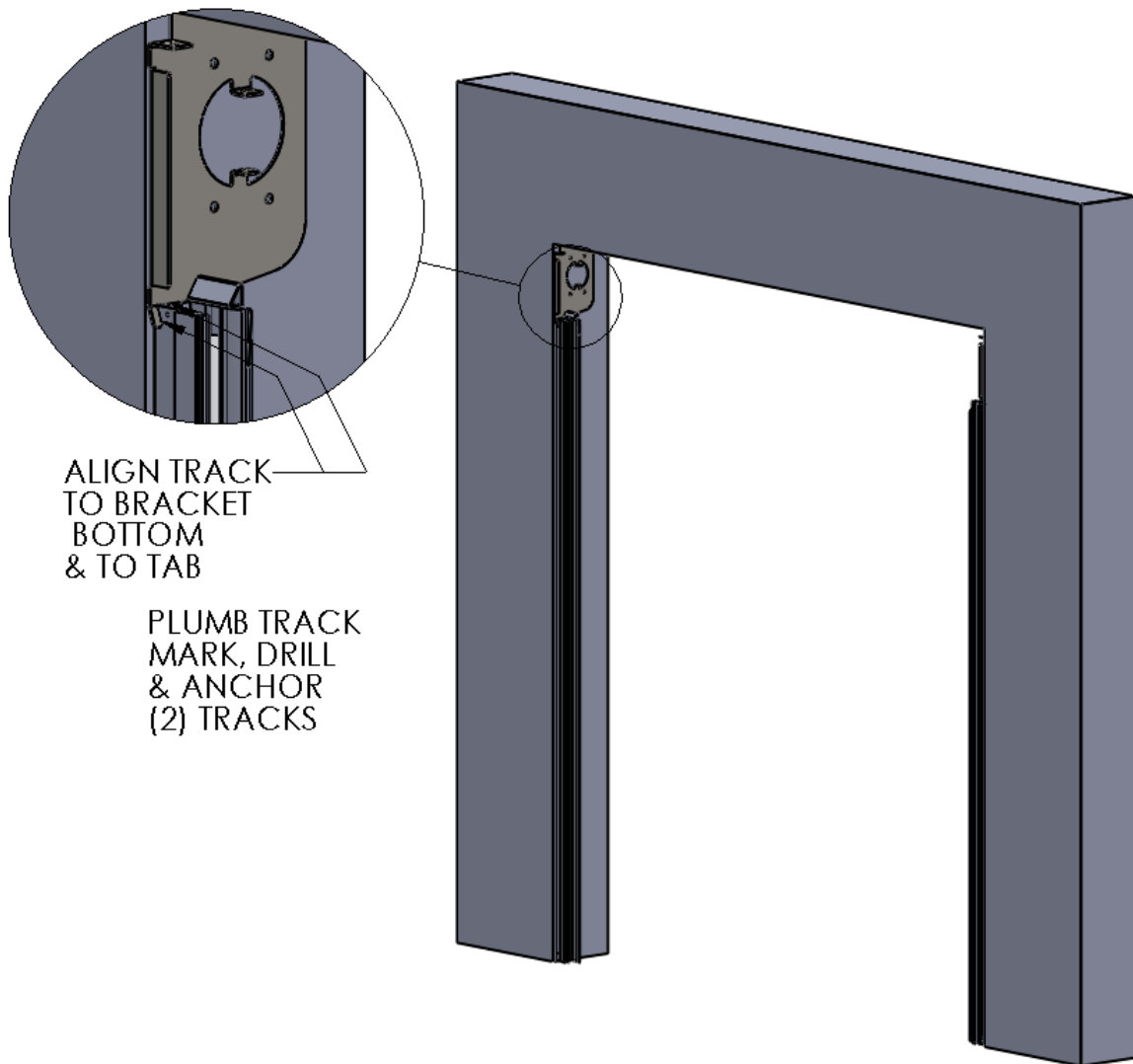

Figure 3 LOCATE, MARK, INSTALL TRACK ASSEMBLIES

### **MOUNT THE HEADER ASSEMBLY**

**NOTE:** Use two (2) people, and two ladders at minimum, to install the Header Assembly.

1. Raise the Header Assembly. Angle the Drive side towards the Header Bracket (it will be installed first), and angle the idle side away from the opening
2. At the right side, insert the Upper Motor Peg fully into upper hole of R.H. Header Mounting Bracket. (Figure 4 INSTALL MOTOR SIDE OF ROLL ASSEMBLY)

3. Slip the plastic Ring onto Lower Motor Peg, then insert the Lower Motor Peg into the lower hole on the Header Mounting Bracket. (Figure 4 INSTALL MOTOR SIDE OF ROLL ASSEMBLY)
4. Insert the plastic Clip onto the Upper Motor Peg to fill space between the Bracket and Motor. (Figure 4 INSTALL MOTOR SIDE OF ROLL ASSEMBLY)

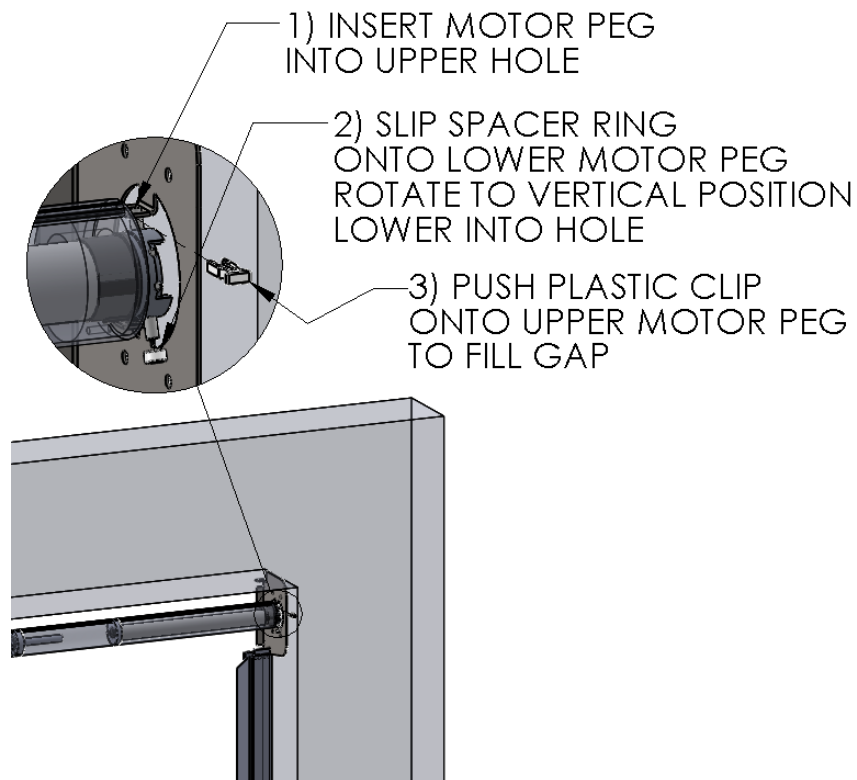

Figure 4 INSTALL MOTOR SIDE OF ROLL ASSEMBLY

5. Pivot the Idle side of the Roll Assembly into the opening. Align the hole in the Idle Shaft with the slot in the Header Bracket, then install Locking Pin. (Figure 5 INSTALL IDLER SIDE OF ROLL ASSEMBLY)

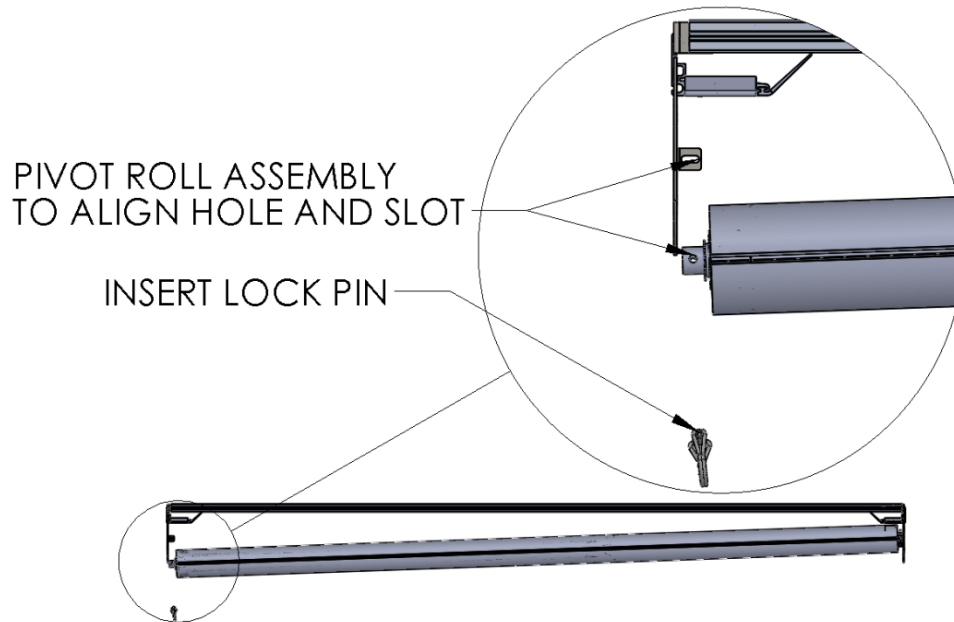

Figure 5 INSTALL IDLER SIDE OF ROLL ASSEMBLY

6. At this point leave the roll assembly tied off and held in place as it comes.

### **MOUNT THE VALANCE ASSEMBLY**

1. Install the Valance Assembly onto the top of the bent flanges of the installed Header Mounting Brackets using the hardware provided in the Valance Beam. (Figure 6 INSTALL VALANCE ASSEMBLY)

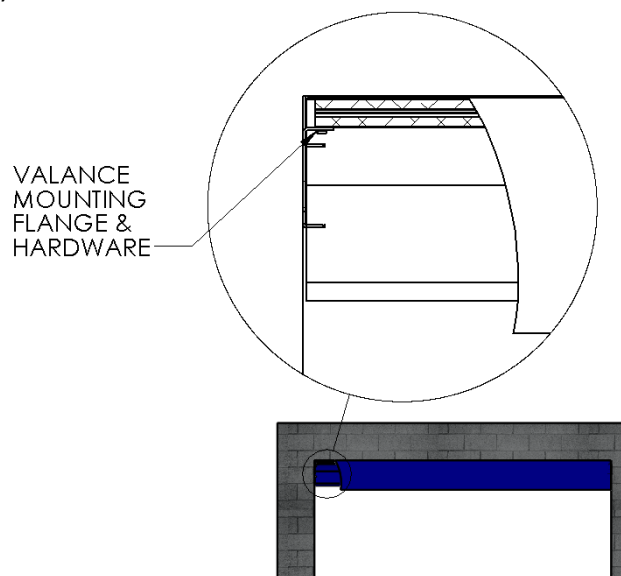

Figure 6 INSTALL VALANCE ASSEMBLY

**CHECK ALL MOUNTINGS AND CONNECT OPERATOR**

1. With everything mounted, take a moment to check all of your hardware, and all of the components for horizontal and vertical alignments.
2. Release the ties on the roll assembly.
3. Have a qualified Electrician mount the Switch Control Box, route, and connect all wiring before applying power to the Door Assembly.

NOTE - See supplemental Instruction for:

“Electrical Connections and Motor Adjustments”

**WARNING**

**ALL INSTALLATION INSTRUCTIONS MUST BE FOLLOWED, AND CRITICAL ALIGNMENT REQUIREMENTS MUST BE MET.**

\*\*\*

**- ENSURE THAT THE ROLL HEADER ASSEMBLY IS LEVEL, AND THAT THE TRACKS AND BRACKETS ARE ALL PLUMB, AND SQUARE-**

\*\*\*

**OTHERWISE, THE PERFORMANCE AND CONSISTENT OPERATION OF YOUR DOOR WILL BE COMPROMISED.**

**LIMITED WARRANTY**

**G2 Doors**

Goff's Enterprises, Inc. warrants all High-Performance Doors from failure in normal use due to defects in material or workmanship for a period of **THREE years** from date of purchase. This warranty includes **all parts and warranty related labor** as approved by Goff's Technical Support Team.

Goff's Enterprises, Inc. may elect to repair or replace defective or damaged goods.

**Technical Support Team: 262-746-3374**

