

G1 SERIES – PROJECTION MOUNTING OVER 12” INSTALLATION INSTRUCTIONS

READ THIS MANUAL CAREFULLY. OBSERVE WARNINGS AND PRACTICE CAUTION WHEN INSTALLING, OPERATING, OR MAINTAINING YOUR GOFF’S DOOR ASSEMBLY.

PREPARE PROJECTION BRACKETS

1. Find the package of Projection Mount Brackets, and a bag with screws, nuts and Velcro strips. (Figure 1 HEADER PROJECTION BRACKETS (LH & RH-SHOWN) & Figure 2 TRACK PROJECTION BRACKETS (8 REQ'D))
2. Verify that the projection distance on all Brackets is the same. (Figure 3 HEADER PROJECTION BRACKET & Figure 4 TRACK BRACKET (8 Req'd))

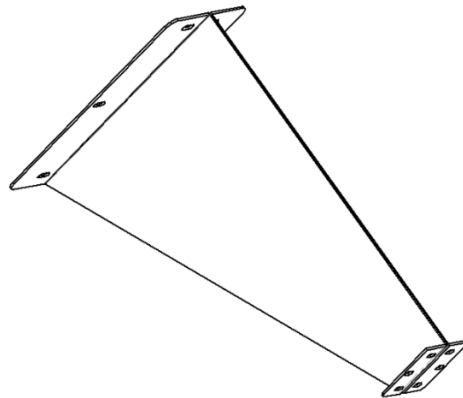

Figure 1 HEADER PROJECTION BRACKETS (LH & RH-SHOWN)

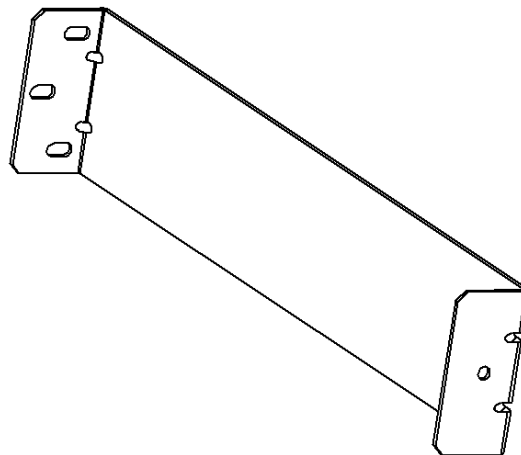

Figure 2 TRACK PROJECTION BRACKETS (8 REQ'D)

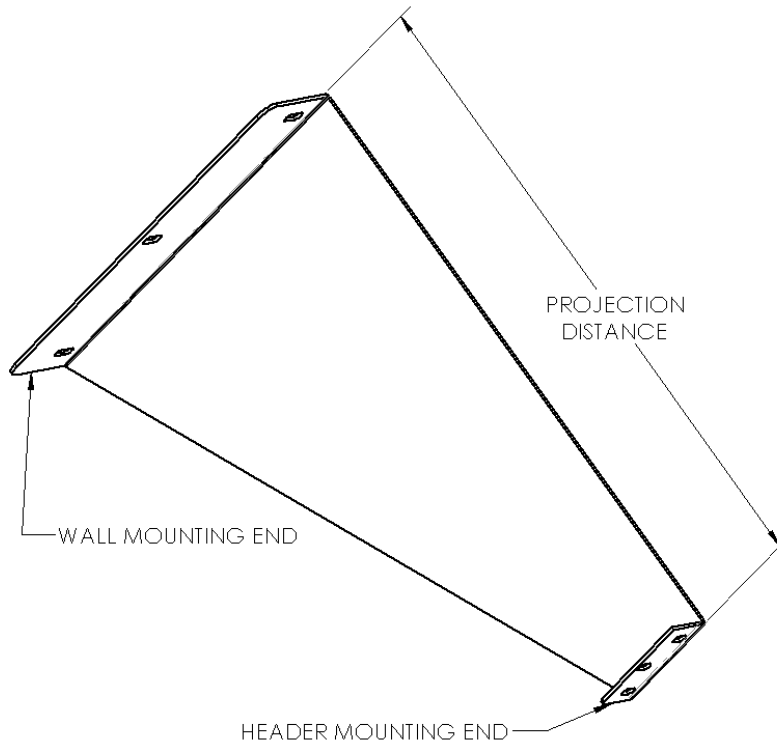

Figure 3 HEADER PROJECTION BRACKET

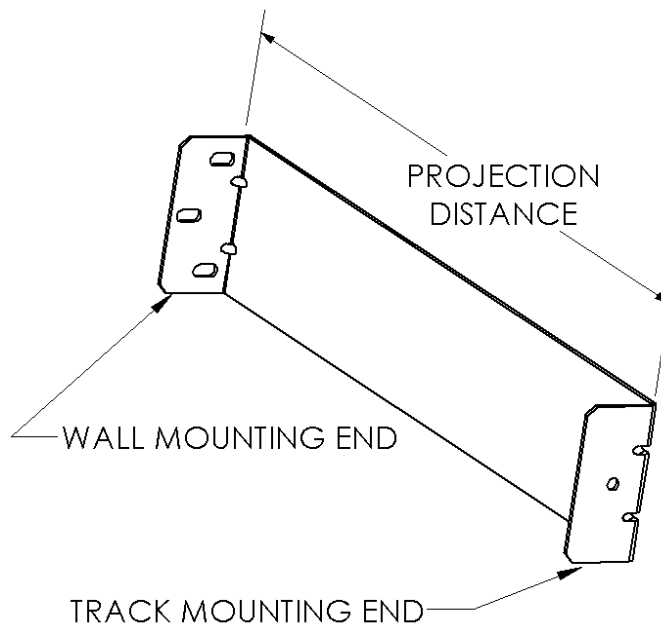

Figure 4 TRACK BRACKET (8 Req'd)

INSTALL HEADER PROJECTION BRACKETS

1. Using the wall end of one of the Header Projection Mount Brackets, trace the insides of its oval mounting slots onto the wall mount surface (a Sharpe permanent marker works great for this). Be sure that its flange is facing outward, that its Top edge is on the height line, and that the outer edge is on your vertical overall width line. (Figure 5 LOCATE/INSTALL HEADER OFFSET MOUNTING BRACKET)
2. Predrill through the centers of the traced locations for the mounting hardware, three (3) pilot holes on each side. Using adequate mounting screws or bolts (depending on your building/surface material) attach the header offset brackets to each side of the opening. (Figure 5 LOCATE/INSTALL HEADER OFFSET MOUNTING BRACKET)

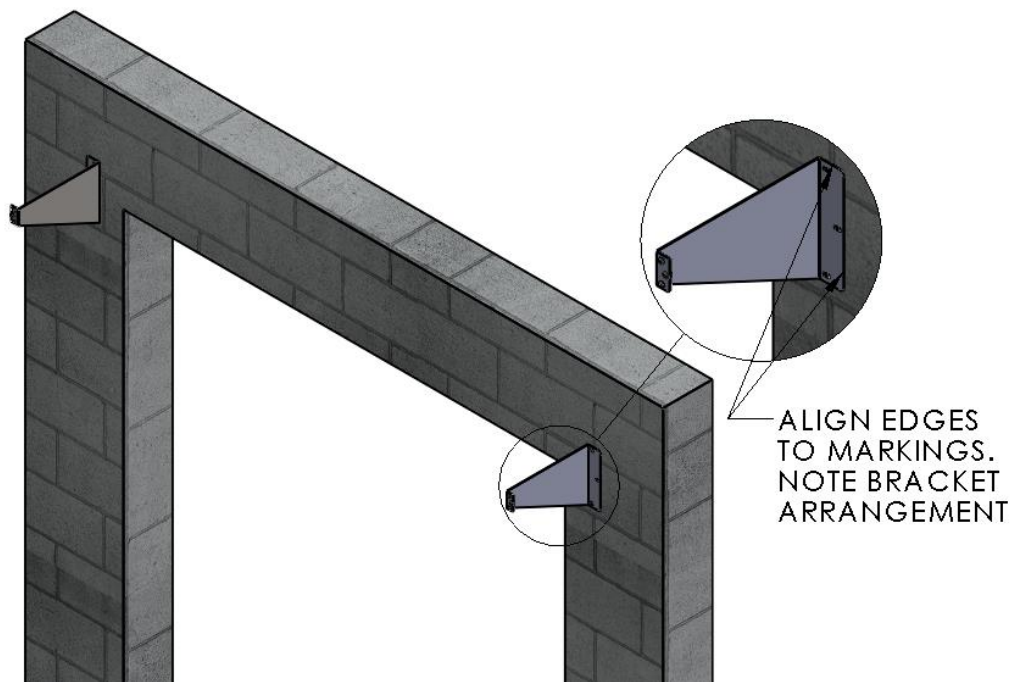

Figure 5 LOCATE/INSTALL HEADER OFFSET MOUNTING BRACKET

RAISE AND ATTACH THE ROLL HEADER ASSEMBLY

1. Using two (2) people, and two ladders at minimum, raise the Roll Header Assembly into place on the offset brackets and secure with three (3) sets of ¼-20 screws and hex nuts per side. Do not fully tighten hardware until the Header Assembly Brackets are aligned with the offset brackets/edges. (Figure 6 MOUNT HEADER ASSEMBLY TO OFFSET BRACKETS)
2. Check the Header Assembly for level, and make any necessary final adjustments. Once aligned, fully tighten all six sets of hardware.
3. At this point leave the roll assembly tied off and held in place as it comes.

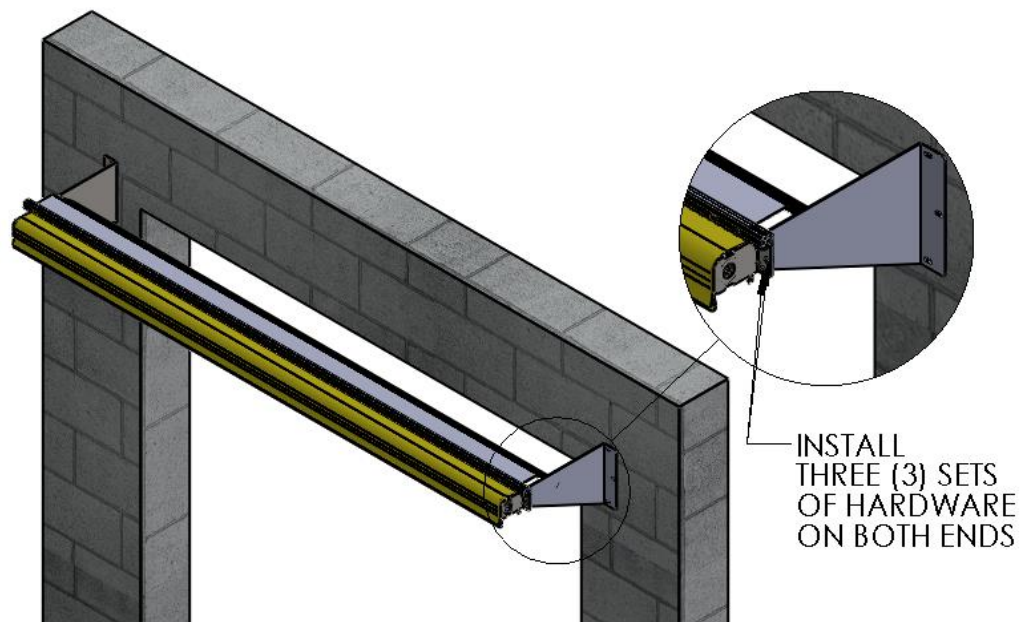

Figure 6 MOUNT HEADER ASSEMBLY TO OFFSET BRACKETS

PREPARE THE VERTICAL TRACK ASSEMBLIES

1. Lay the two Vertical Track Assemblies on your work surface, and un-roll the Side Seal material.
2. The tracks have hardware for the offset brackets to be mounted. Also note that they are marked for orientation as left side, and right side.
3. Locate the Track Projection Mount Brackets, four (4) per track. Using the hardware in the Track Assembly, attach these brackets so that they are oriented vertically, i.e. so that they are parallel to the Track (NOT horizontally oriented). (Figure 7 TRACK OFFSET BRACKET ARRANGEMENT)
4. Fully tighten these brackets once they are evenly aligned with the track edges. Re-install the plug caps into the hardware access holes on the front side of these tracks.

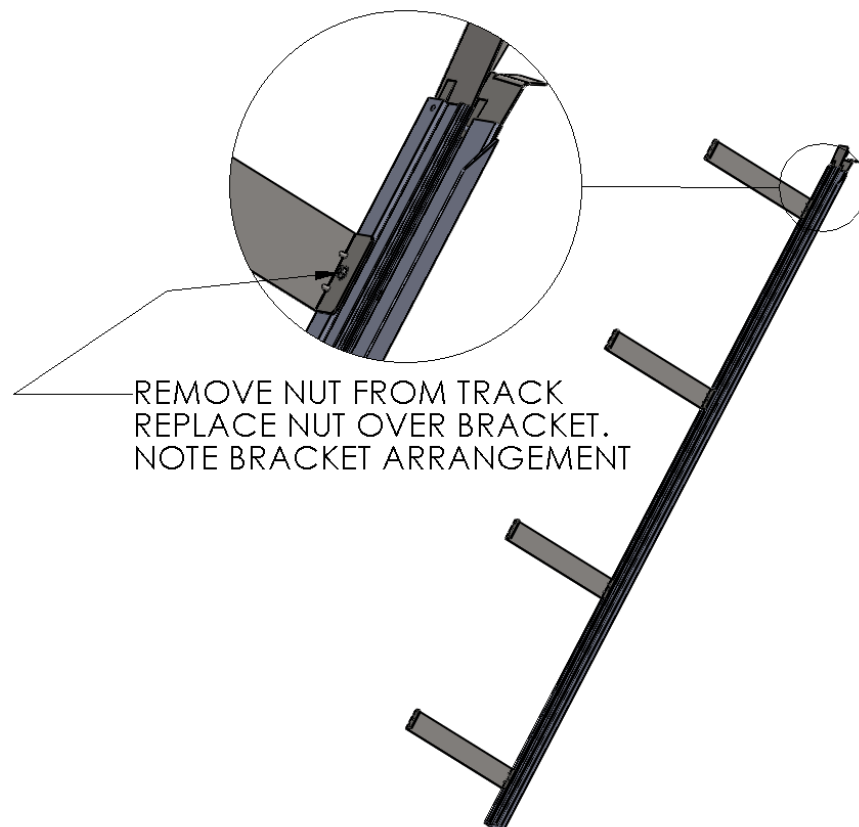

Figure 7 TRACK OFFSET BRACKET ARRANGEMENT

MOUNT THE VERTICAL TRACKS

1. Starting with either left or right side, locate the Track Mounting Hardware in the Track Transition Bracket. (Figure 8 TRACK MOUNTING HARDWARE)
2. Remove the nut and washer leaving the carriage bolt in place. From the inside of the Header Mounting Bracket, loosely “hang” the track assembly, by the carriage bolt, through the square hole of both brackets. (Figure 9 MOUNT TRACK TO HEADER)
3. Re-install the washer and nut onto the carriage bolt loosely mating the two brackets. Note that the Transition Bracket of the Track Assembly should be inside of the Header Bracket tab. (Figure 9 MOUNT TRACK TO HEADER)
4. With the track “hanging” in this position, plumb the track to make sure it is vertically aligned, and that its standoff brackets are touching the wall/mount surface. Trace the oval shaped mount holes on the wall to mark their pilot hole locations. You may need a second person to hold the Track in place, while another person marks the holes.
5. Move the track assembly off to the side and predrill its mounting holes. Move it back into place and secure it to the wall with appropriate hardware. Be sure to plumb each track / check vertical alignment before re-tightening hardware. NOTE: The Track to Header Hardware will be removed and replaced, again, in the next step, so snug them for now.

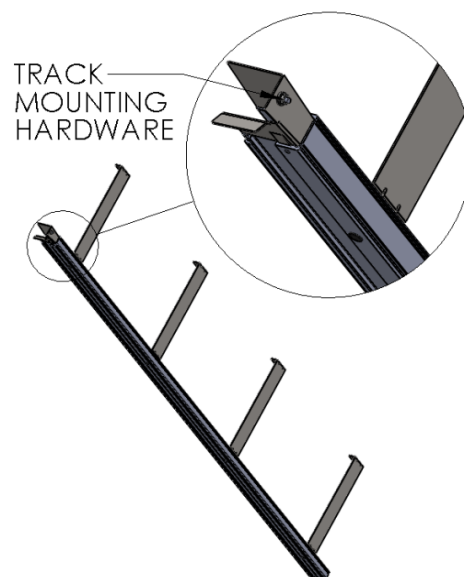

Figure 8 TRACK MOUNTING HARDWARE

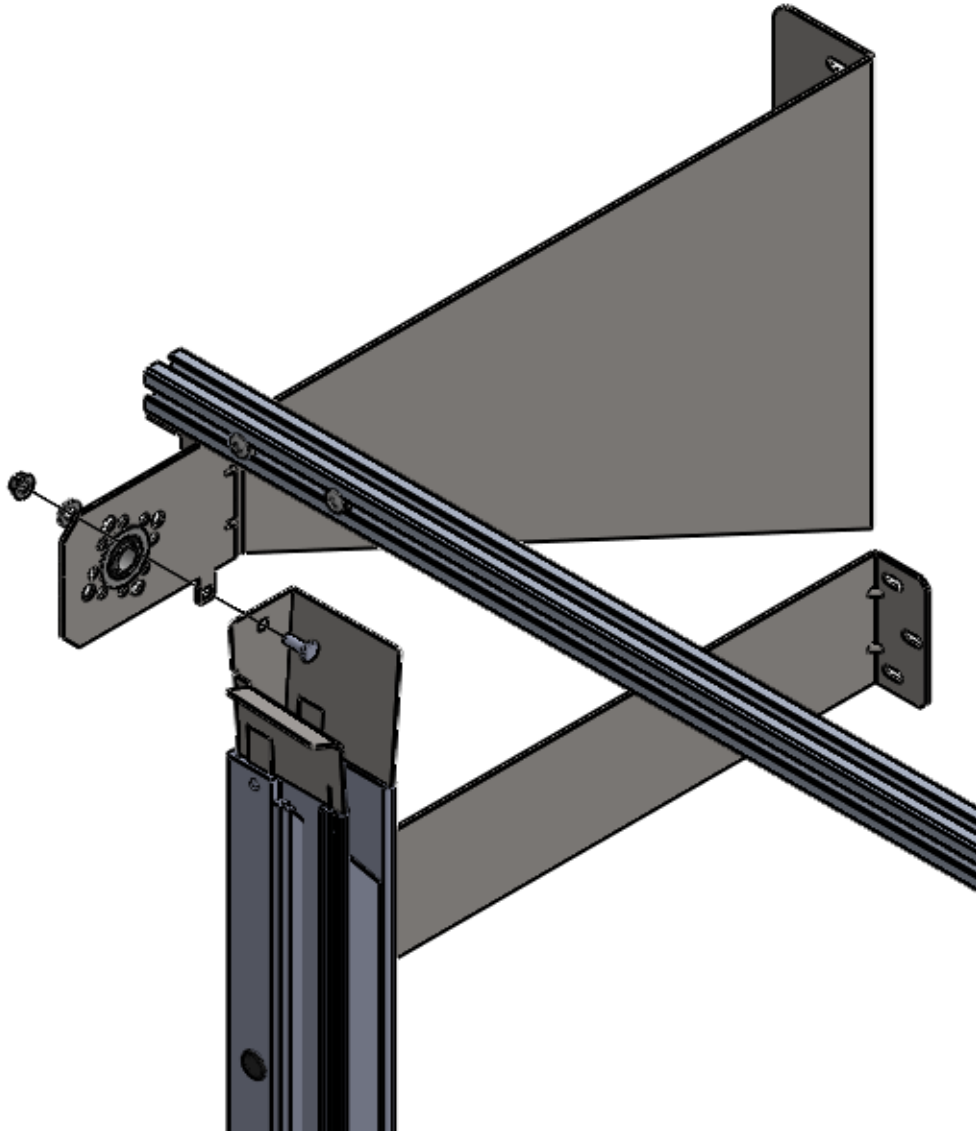

Figure 9 MOUNT TRACK TO HEADER

MOUNT THE SIDE SEAL

1. Remove the nut and washer from the Track Transition Bracket, and re-install them over the Side Seal grommet. Secure the top edge of the Side Seal to the Header Projection Brackets via the hook-and-loop strips provided in the hardware bag.
(Figure 10 SECURE SIDE SEAL)
2. Fold the Side Seal Material to flatten it against the wall, and secure it through the material into the wall with appropriate screws. (Figure 10 SECURE SIDE SEAL)

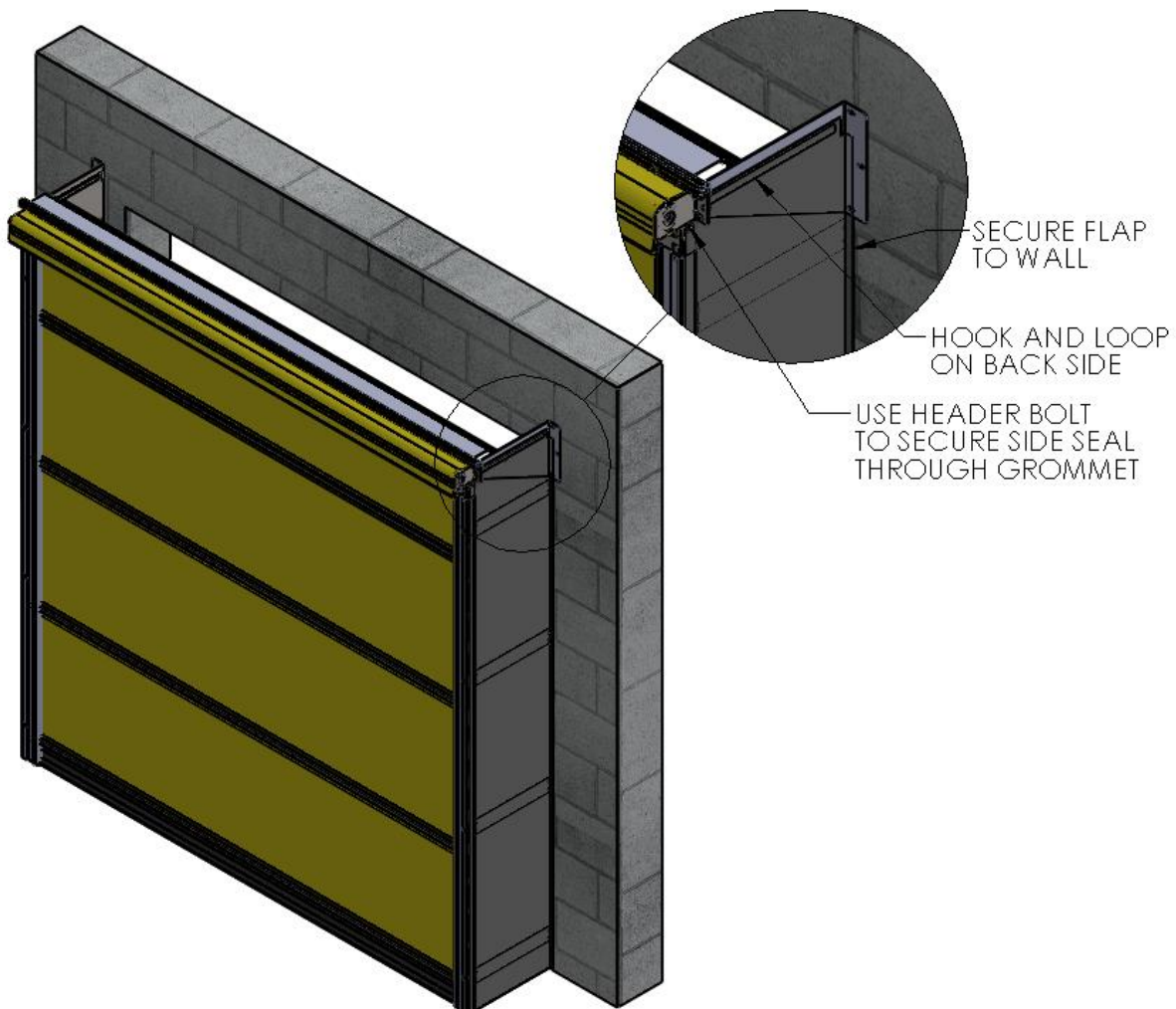

Figure 10 SECURE SIDE SEAL

WARNING

ALL INSTALLATION INSTRUCTIONS MUST BE FOLLOWED, AND CRITICAL ALIGNMENT REQUIREMENTS MUST BE MET.

- ENSURE THAT THE ROLL HEADER ASSEMBLY IS LEVEL, AND THAT THE TRACKS AND BRACKETS ARE ALL PLUMB, AND SQUARE-

OTHERWISE, THE PERFORMANCE AND CONSISTENT OPERATION OF YOUR DOOR WILL BE COMPROMISED.

LIMITED WARRANTY

G1 Bug Screen/Vinyl Doors



Goff's Enterprises, Inc. warrants all G1 bug screen/vinyl doors from failure in normal use due to defects in material or workmanship for a period of **TWO years** from date of purchase with warranty related labor for the first year as approved by Goff's Technical Support Team.

Goff's Enterprises, Inc. may elect to repair or replace defective or damaged goods.

Technical Support Team: 262-746-3374